

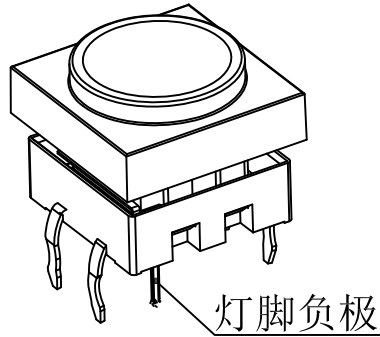

宏聚电子五金制品有限公司

HONGJU ELECTRONIC & METAL PRODUCTS CO.,LTD

TS12

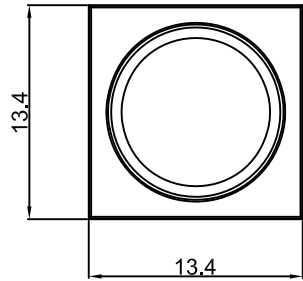

Specifications
 Circuit :SPST
 Current rating :50mA
 Voltage rating :12VDC
 Dielectric withstanding voltage:250VAC for 1 minute
 Contact resistance :100mΩ Max.(Inital)
 Insulation resistance :100MΩ Min
 Operating force :250±50gf
 Total travel :0.4mm±0.15mm
 Operating life :500,000 CYCLES Min
 Solder specifications :256° C for 5 seconds
 Function :Momentary
 Operating temperature :+10° C ~ +60° C

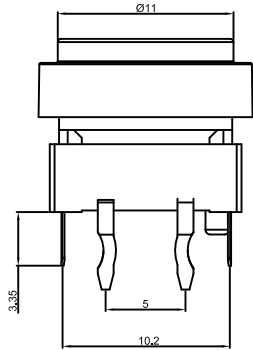
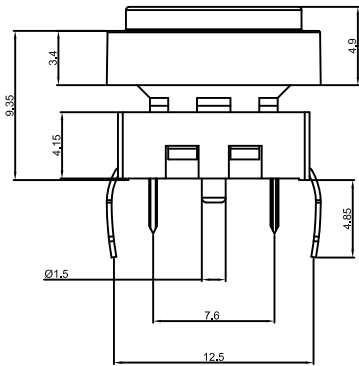

MATERIAL:

Base Frame:Nylon66,UL rated:94V-2 Min. ;
 Actuator: PC, UL rated:94V-2 Min. ;
 Top Cover: PC; UL rated:94V-2 Min. ;
 Terminal:Brass with Golden-plate.

| | |
|---------------------------|-----------|
| R | Red 红色 |
| Y | Yellow 黄色 |
| G | Green 绿色 |
| U | Blue 蓝色 |
| W | White 白色 |
| B | Black 黑色 |
| A | Gray 灰色 |
| Cap Color (X) 上盖颜色 (X) | |

P.C.B.LAYOUT

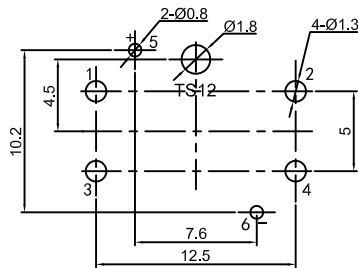

CIRCUIT

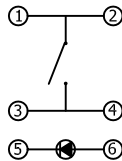

| U2 蓝色5V | 5.0 | 6.0 | 7.0 | 20 | 80 | 465 | 475 |
|--|---------|-----|-----|-------------|-------------|----------|-----------|
| G2 黄绿5V | 5.0 | 6.0 | 7.0 | 20 | 80 | 566 | 576 |
| R2 红色5V | 5.0 | 6.0 | 7.0 | 20 | 80 | 635 | 645 |
| U1 蓝色 | 2.8 | 3.2 | 4.2 | 25 | 100 | 460 | 470 |
| G1 黄绿色 | 1.8 | 2.3 | 2.6 | 30 | 100 | 565 | 575 |
| Y1 黄色 | 1.8 | 2.2 | 2.6 | 30 | 100 | 583 | 595 |
| R1 红色 | 1.6 | 1.8 | 2.3 | 20 | 100 | 630 | 645 |
| Clip emitted color (XX) 灯的发光颜色 (XX) | 最小 | 一般 | 最大 | 最大操作电流 (mA) | 最大脉冲电流 (mA) | 主波长 (nm) | 峰值波长 (nm) |
| | 顺向电压(V) | | | | | | |

| | | | | | | | | | | | |
|---------|-------------------------|------------|---------|---------------|----|-------------------|--------|---------------|------------|-----------------------|--|
| | | | | 公差 TOLERANCES | | .X± 0.3 .XX± 0.15 | | 角度 ANGLE ± 1° | | 单位 DIMENSION UNIT mm. | |
| | | | | 版本 VERSION | A1 | 比例尺 SCALE | NONE | 日期 DATE | 2020.07.10 | 品名 TITLE | |
| | | | | 核准 | | 核对 | Z.H.B. | 绘图 | | 图号 DRAWING NO | |
| A1 | 重新整理发行 | 2020.07.10 | N/A | APPROVED BY | | CHECKED BY | | TS12 -3T-R1 | | TS12 -3T-R1_A1 | |
| 版本 VER. | 变更说明 CHANGE DESCRIPTION | 日期 DATE | ECN NO. | APPROVED BY | | CHECKED BY | | DRAWN BY | | | |